

(Page 9)

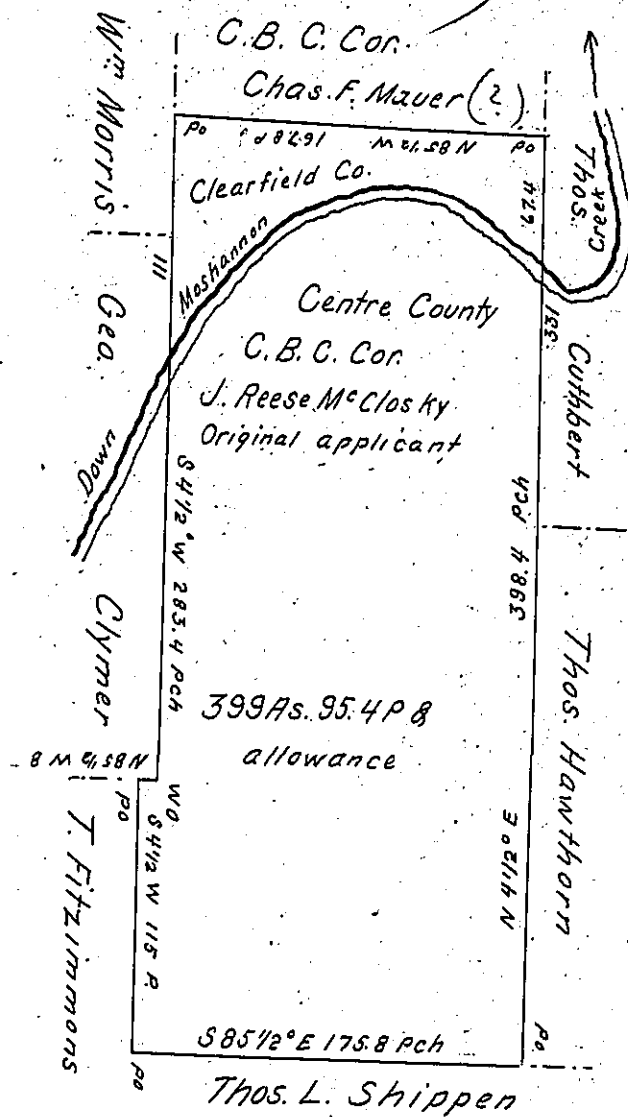

A Draft of a tract of land situated in the Townships of Cooper formerly Morris and ~~and~~ County of Clearfield, containing Three hundred ninety-nine acres, 95 4/10 perches and allowance of six per cent. for roads, etc. Surveyed the 11th day of November 1894, in pursuance of a warrant granted to Clearfield Bituminous Coal Corporation Assignees of D. B. Kunes and Wm A. Reed Assignees of ~~to~~ J. Reese McClosky Original Applicant dated the 14th day of May 1894.

To James W. Latta, Esq.,
Secretary of Internal Affairs } J. W. Reitsnyder
County Surveyor, of
Centre County
Harry Byers, County Surveyor
of Clearfield Co.

IN TESTIMONY that the above is a copy of the original remaining on file in the Department of Internal Affairs of Pennsylvania, made conformably to an Act of Assembly approved the 16th day of February, 1833, I have hereunto set my Hand and caused the Seal of said Department to be affixed at Harrisburg, this sixth day of July 1904.

James R. Brown
Secretary of Internal Affairs.